

RANGE OF USE

Flow rate up to:	74 m ³ /h
Mano. head up to:	30 mCE
Frequency range:	+ 5° at 80°C
Max. operating pressure:	6 bar
Opening ND:	40 à 80

TP 2800

SELF-PRIMING CENTRIFUGAL PUMPS Depleting - Draining 50 Hz

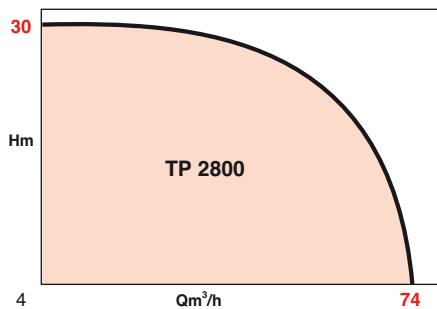

APPLICATIONS

- Depletion of groundwater from excavations and public works sites.
 - Draining of flooded cellars and car parks.
 - Watering, irrigation.
 - Depletion of percolation water...
- And for the pumping of all clear, dirty and slightly muddy water.

ADVANTAGES

- Automatic priming.
- Suction without obstruction up to max. 7.50 m.
- Ease of intervention: inspection panel allowing for rapid cleaning of the wheel inlet (except TP 2802).
- Wheel, diffuser and wear plate easy to replace.

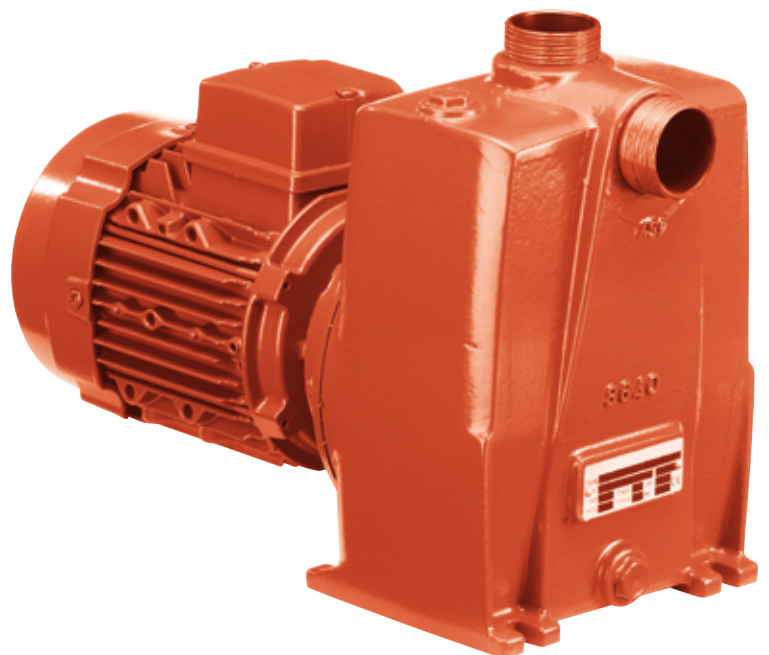
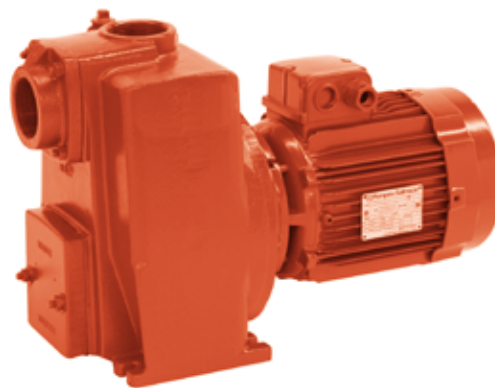

TP 2800

BASIC CONSTRUCTION

• Hydraulic section

- Self-priming centrifugal pump.
- Pump housing with priming tank and inspection panel for cleaning of the wheel inlet (except TP 2802).
- Filling plug.
- High-resistance open wheel.
- Mounting brackets under the pump housing.
- Anti-return valve at suction point (except TP2802).

• Electric motor

Speed:	2900 rpm
Three-phase winding:	230 - 400 V
Frequency:	50 Hz (option 60 Hz)
Insulation class:	155 (F)
Protection index:	IP 55
CE conformity:	EN 809

STANDARD STRUCTURE

Main parts	Material
Housing TP 2802	Aluminium
other types	Cast iron EN GJL 250
Open wheel	Cast iron EN GJL 250*
Diffuser	Cast iron EN GJL 250
Pump shaft	Steel X30Cr13
Mechanical seal	
TP 2802	Carbon/Aluminate/Nitrile
Other types	Carbide/Carbide/Nitrile
	* Molybdenum

IDENTIFICATION

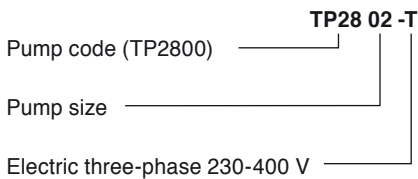

ORIGINAL SECTIONAL DRAWING

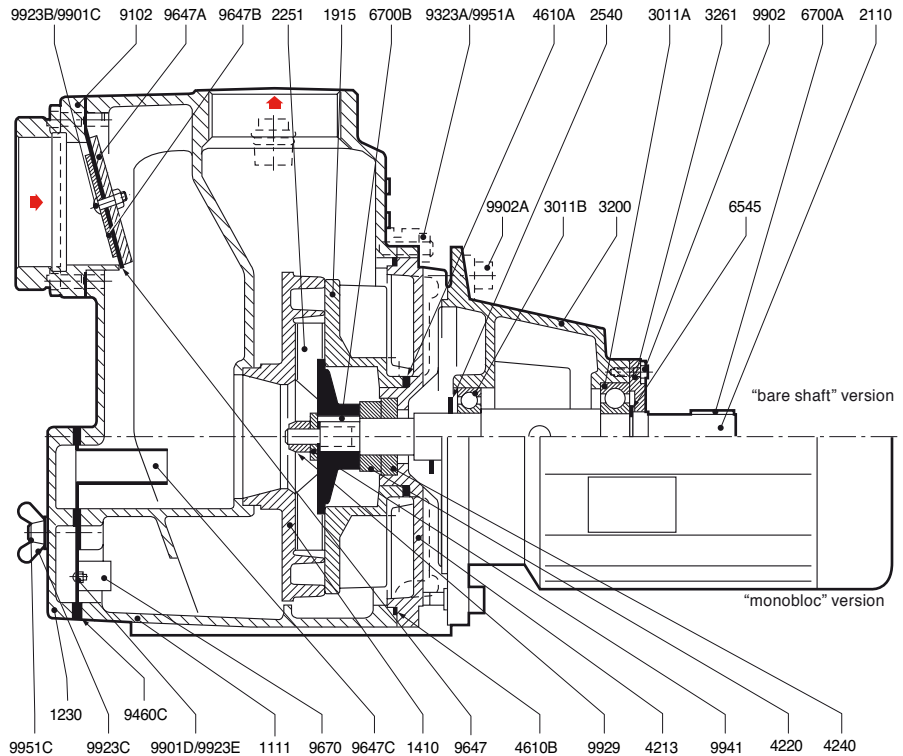

- 1111 - Pump housing
 - 1230 - Inspection door
 - 1410 - Diffuser
 - 1915 - Wear plate
 - 2251 - Open wheel
 - 2540 - Deflector
 - 3127A - Adjustment washer
 - 3127B - Adjustment washer
 - 4213 - Grain carrying end plate
 - 4220 - Rotating seal section
 - 4240 - Fixed mechanical section
 - 4610A - O-ring (wear plate / end plate)
 - 4610B - O-ring (housing / end plate)
 - 6700B - Wheel key
 - 8020 - Electric motor
 - 9102 - Suction tube
 - 9460C - Inspection door seal
 - 9621 - Filling plug
 - 9647 - Anti-return valve at suction point
 - 9647A - Upper valve head
 - 9647B - Lower valve head
 - 9647C - Plate + ejector
 - 9670 - Ejector spring
 - 9901C - Valve head attachment screw
 - 9901D - Ejector spring attachment screw
 - 9923A - Nut (end plate / housing)
 - 9923B - Nut (valve heads)
 - 9923C - Wing nut (inspection door)
 - 9932E - Nut (ejector spring)
 - 9929 - Wheel blocking nut
 - 9941 - Washer under wheel nut
 - 9951A - End plate / housing attachment dowel
 - 9951C - Inspection door attachment dowel
- (*) Recommended spare parts

HYDRAULIC PERFORMANCES WITH ELECTRIC MOTOR

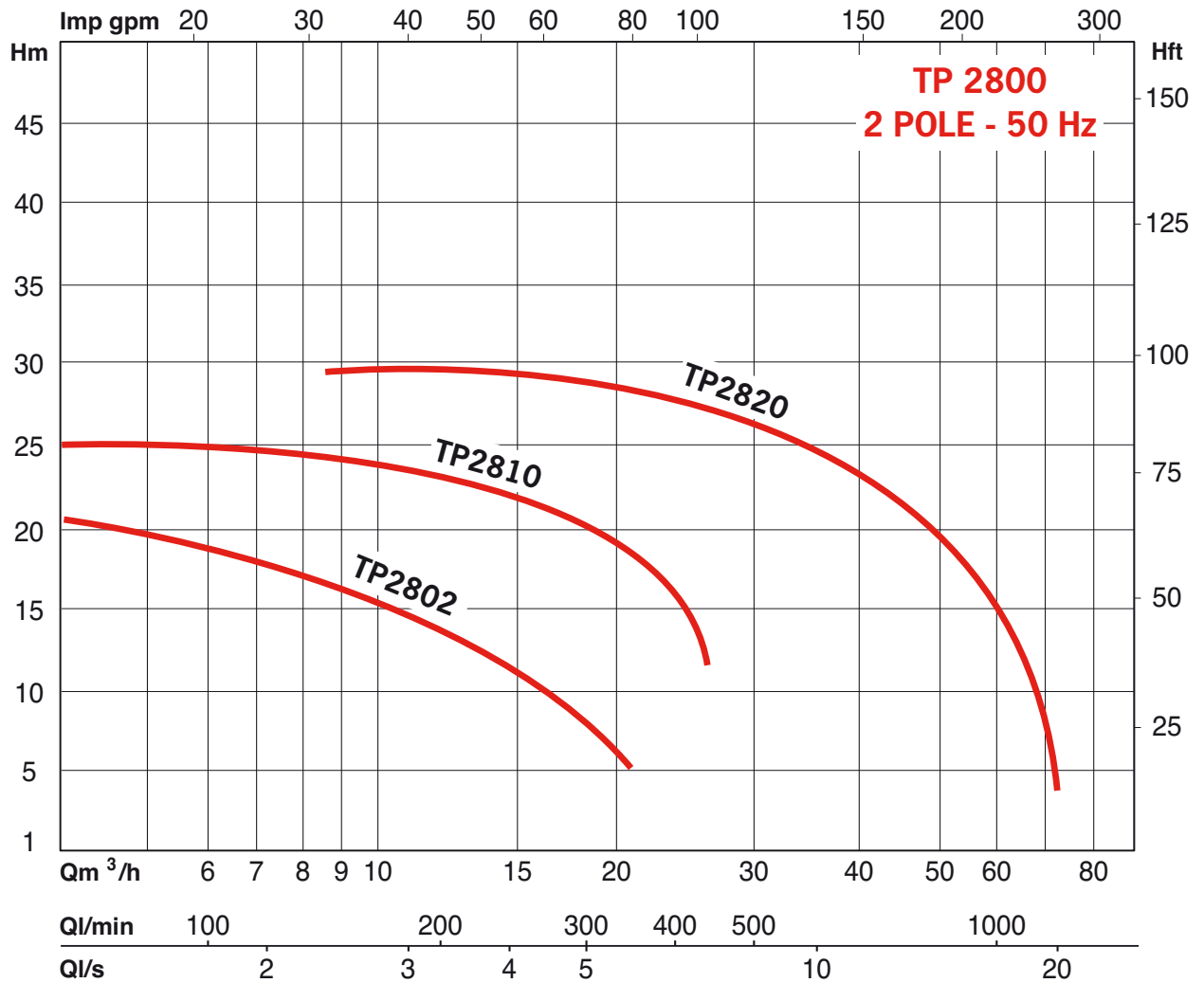

TP 2800

ELECTRICAL AND DIMENSIONAL CHARACTERISTICS

• Monobloc version "T"

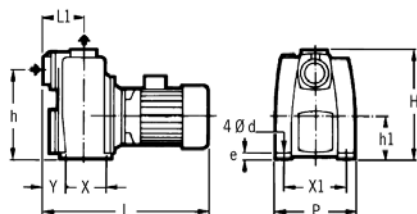

ORDER REFERENCE	P2 motor	nom. I		openings		H	L	P	h	L1	X	X1	Y	Ød	e	mass	particle size*
		A	A	mm	mm	mm	mm	mm	mm	mm	mm	mm	mm	mm	mm	kg	
TP 2802-T	1.1	4.5	2.6	1 1/2" M	293	399	184	238	087	122	140	31	10	10	19	6	
TP 2810-T	2.2	7.7	4.4	2" F	311	484	229	249	118	129	180	64	10	14	43	6	
TP 2820-T	4.2	14.2	8.2	3" F	363	583	260	288	174	190	210	94	14	19	75	12	

* Particle size at wheel level

SYMMETRICAL QUICK-FITTING PIPE UNIONS



Connection kit

Threaded female sockets – without lock
Grooved male sockets – with lock

ORDER REFERENCE	Item code	Pump
P*DN40 TAR G1 1/2 - CAN.REDØ40	4045031	TP2802
P*DN50 TAR G2 - CAN.REDØ50	4045032	TP2810
P*DN40 TAR G3 - CAN.Ø90	4045464	TP2802

Other kit

ORDER REFERENCE	Item code	Pump
P*DN32 CAN./CAN.Ø35	4045064	Tuyau/tuyau
P*DN40 CAN.RED./CAN.REDØ40	4045025	Tuyau/tuyau
P*DN50 CAN.RED./CAN.REDØ50	4045026	Tuyau/tuyau
P*DN65 CAN./CAN.Ø70	4045027	Tuyau/tuyau
P*DN80 CAN./CAN.Ø90	4045028	Tuyau/tuyau
P*DN100 CAN./CAN.Ø110	4045029	Tuyau/tuyau



Connection kit

Threaded male sockets – without lock
Grooved male sockets – with lock

ORDER REFERENCE	Item code	Pump
P*DN50 FIL. G2 - CAN.REDØ50	4027321	TP2810
P*DN80 FIL. G3 - CAN.Ø90	4044981	TP2820

Other kit

ORDER REFERENCE	Item code
P*DN32 FIL. G1 1/4 - CAN.Ø35	4045062
P*DN40 FIL. G1 1/2 - CAN.REDØ40	4027322
P*DN65 FIL. G2 1/2 - CAN.Ø70	4013186

FEATURES

a) Electrical

- All types (T) three-phase 230-400 V - 50 Hz.
- Protection of electric motor by overcurrent release essential.
- Connection to motor terminal board by cable gland.

b) Assembly

- On solid base, horizontal axis
- Attachment on brackets supporting pump housing
- Connection to the installation by optional symmetrical quick-fitting pipe unions

c) Packaging

- Delivered without connection accessories.

d) Maintenance

- Pump and motor, repair and replacement of spare parts recommended (*) liable to wear.

OPTIONS AND ACCESSORIES

- Barrow version.
- Suction strainer.
- Protective motor overcurrent release
- Anti-return valve.
- Shut-off valve
- PVC piping or textile structure.

- Connection, suction and discharge accessories. (see below)
- Control and protection unit YN 7000, 1~ 230 V or 3~230/400 V - 50Hz - IP54 - 1 à 23 A



Connection accessories:

Grooved socket

For flexible pipe to be assembled on the elbow

Order reference	item code
SOCKET FC1 1/2"	018820
SOCKET MC2"	018821
SOCKET MC3"	018822

